

Accessories and spare parts

Accessori e ricambi

PVC-U UNION END - SOLVENT WELDED METRIC PVC-U PEZZO FOLLE BOCCHETTONE - INCOLLAGGIO METRICO

Rev. Oct 2019

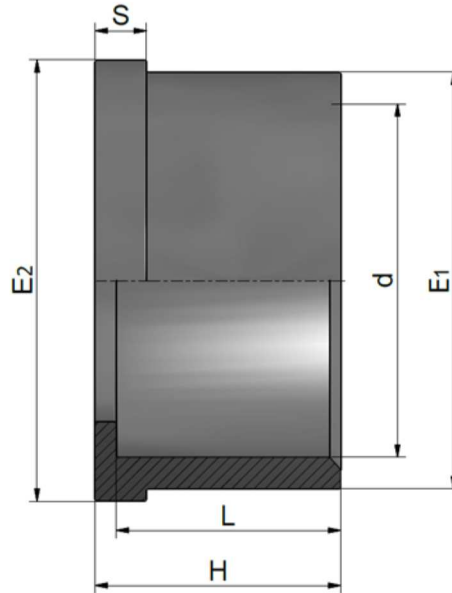

Code	d	L	H	E1	E2	S	PN	Weight (g)
RDRBLD0160	16	14	18	22	24	7	16	6
RDRBLD0200	20	16	19	28	30	5	16	10
RDRBLD0250	25	19	22	34	39	6	16	16
RDRBLD0320	32	22	25	41	44,5	6	16	22
RDRBLD0400	40	27	30	51	56	7,5	16	40
RDRBLD0500	50	31	35	59	62	7	16	45
RDRBLD0630	63	38	42	74	78,5	7	16	80
RDRBLD0750	75	44	48	90	96	10	16	150
RDRBLD0900	90	51	56	105	110	13	16	195
RDRBLD1100	110	61	66	129	135	13	16	350



NSF and WRAS certifications: only for valves with EPDM seals. Certifications and approvals are related to items declared on Official Listing or certificates. /
Certificazioni NSF e WRAS: valide solo per le valvole con guarnizioni EPDM. Le certificazioni si riferiscono ai prodotti dichiarati nelle Official Listing o sui certificati stessi.

All descriptions and illustrations in this publication are intended for guidance only and shall not constitute a 'sale by description'. All dimensions given are nominal, while changes can be done on the information, products and specifications from time to time for a variety of reasons, without prior notice. The information in this publication is provided 'as is' on the revision date stated on the sheet. Updates will not be issued automatically. This information is not intended to have any legal effect, whether by way of advice, representation or warranty (express or implied). We accept no liability whatsoever (to the extent permitted by law) if you place any reliance on this publication you must do so at your own risk. All rights reserved. Copyright in this publication belongs to Polypipe Italia and all such copyright may not be used, sold, copied or reproduced in whole or part in any manner in any media to any person without prior consent. **EFFAST** is a registered trademark.